

BABY WOLF LOOM

ASSEMBLY INSTRUCTIONS FOR KNOCKED-DOWN LOOMS

HARDWARE LIST

FIGURES 1, 2, & 3 HARDWARE BAG

- 4 Fold-up supports
- 2 Black fold-up knobs w/ 1" threaded shaft
- 2 Plastic bearings
- 4 3/16" x 1-1/4" carriage bolts
- 4 3/16" lock nuts
- 8 3/16" washers
- 2 5/16" lock nuts
- 4 1/4" x 2" truss head machine screws
- 4 1/4" barrel nuts
- 2 #8 x 1-1/2" truss screws
- 4 1/4" washers
- 2 1/4" wing nuts
- 2 1/4" x 2-1/2" carriage bolts
- 1 3/8" SAE washer

FIGURES 4 & 5 HARDWARE BAG

- 1 Ratchet advance lever assembly
- 2 3/8" USS washers
- 2 5/16" slim lock nuts
- 4 #8 x 1-1/2" truss screws
- 2 1/4" x 2" truss machine screws
- 2 1/4" barrel nuts

FIGURE 6 HARDWARE BAG

- 2 Aluminum rods (jack pivot rods)
- 2 1/4" Carriage Bolts (4-1/2" for 4S, 7" for 8S)
- 3/8" SAE washers (14 for 4S, 22 for 8S)
- 2 1/4" washers

- 2 1/4" locknuts
- 4 #8 x 1-1/2" truss screws

FIGURES 7 & 8 HARDWARE BAG

- 2 1/4" x 2" truss machine screws
- 2 1/4" barrel nuts
- 2 #8 x 1-1/2" truss screws
- 2 #8 x 1-1/4" truss screws (for 4N4L & 8S)
- small hex nuts (4 for 4S, 8 for 8S)
- small black O-rings (4 for 4S, 8 for 8S)

FIGURE 9 HARDWARE BAG

- 2 3/8" USS washers
- 1 Brake bar and cable
- 1 Nylon brake cord
- 1 S-hook
- 1 Plastic brake peg
- 2 1/4" washers
- 1 Brake bar eye bolt
- 1 Brake spring with insert
- 1 Brake barrel nut (long)
- 1 5/16" slim lock nuts
- 1 3/16" washer
- 2 1/4" x 2" truss machine screws
- 1 1/4" x 1" truss machine screw

FIGURE 10 HARDWARE BAG

- 1 Beater pin and chain
- 1 Beater pin holder
- 1 #6 x 5/8" truss head screws
- 2 1/4" barrel nut
- 2 Fender washers
- 2 Black knobs with 2-1/4" threaded shafts



Find out more at schachtspindle.com

Schacht Spindle Company 6101 Ben Place Boulder, CO 80301

© 2011 Schacht Spindle Company, Inc.
P. 303.442.3212 F. 303.447.3273

07.11

BABY WOLF LOOM

ASSEMBLY INSTRUCTIONS FOR KNOCKED-DOWN LOOMS

- Unpack the Wolf loom parts carefully. Do not throw away the carton or any of the packing material until you have checked to see that all of the parts and hardware have been received
- All hardware is sized in inches. Illustrations of the various hardware and an inch scale are provided to aid you in determining the correct piece of hardware to use.
- Before starting the assembly, read the instructions completely and familiarize yourself with the drawings and parts.
- Follow the exact order of assembly. Take care and work slowly. If you have someone to help you the assembly will be easier.
- When you finish assembling the Wolf loom, go back over all of the screws and bolts to make sure they are tight. It is a good idea to retighten the screws every few months. Remember not to tighten those screws and bolts which are supposed to allow their parts to pivot freely.
- All wooden parts of the loom have been finely sanded and finished with a hand-rubbed Danish oil. From time to time you may wish to apply more finish to the loom. Use a Danish oil (tung oil and polyurethane mixture) and hand rub the wood with a soft, lint-free cloth.

Note: Washer sizes are measured by the diameter of the hole. 3/8" USS washers have a larger outside diameter than 3/8" SAE washers.
Listed part quantities are what is needed for assembly. There may be extras of some parts.

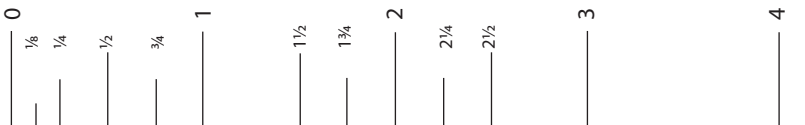
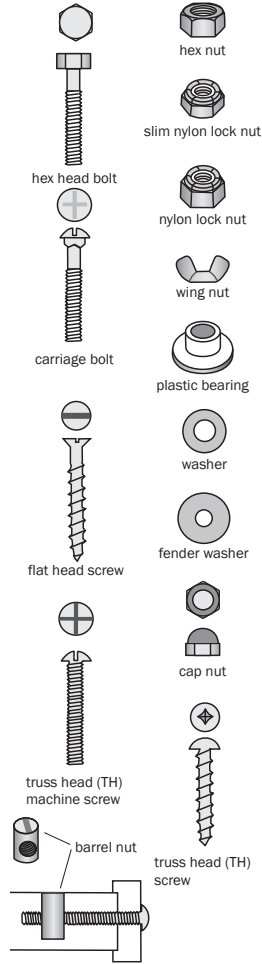

ASSEMBLY INSTRUCTIONS

1. You may find it helpful to detach the pages containing the figures so you can more easily refer to them while reading the instructions.

FIGURE 1

2. Attach (3/16" x 1-1/4" carriage bolt at C) the fold-up supports (5 & 6) and (7 & 8) to legs (1 & 3) and (2 & 4). Secure them with two washers (one washer on each side of the leg) and a 3/16" lock nut. Be sure that the square part of the carriage bolt fits into the square hole in the fold-up support. The fold-up supports should be just loose enough to pivot freely. The bend in the support faces in toward the loom.

3. Attach the castle sides (9 & 10) to the leg assemblies. Secure with 1/4" washers and 5/16" lock nuts. Tighten the lock nuts enough to allow the castle sides to pivot freely.

FIGURE 2

4. Insert fold-up knobs (K) through the fold-up support (5 & 6) and (7 & 8) and through plastic bearing (P), and screw them into the large aluminum nut that is already inside the castle sides (look for it at the bottom of the slot). It is very important to make sure the fold-up supports are in the same order as shown in the drawing. Be sure the rear fold-up supports overlap the front ones. Open the loom as far as it will go and secure in this open position by tightening the fold-up knobs.

FIGURE 3

5. Attach (1/4" x 2" truss machine screws and barrel nuts and #8 x 1-1/2" truss screws) the shuttle race (20) to the beater sides (21 and 22). Use the smaller #8 truss screws for the front of the beater, and the 1/4" truss screws for the back. Attach (1/4" x 2-1/2" carriage bolt, washers, and wing nuts) the beater tops (23). Set the beater aside.

FIGURE 1

6. Attach the treadle assembly (12) to the legs (3 & 4). Place the brake pedal (5) at the right side of the loom. Line up the pin at the end of the treadle bar with the small hole in the legs, and the treadle bar (11) with the 3/8" hole in the legs. Insert a 1/4" x 2" truss machine screw into each leg from the outside and place a 1/4" barrel nut into the hole on each side of the underside of the treadle support (12). Tighten the screws firmly into the barrel nuts.

FIGURES 4 AND 5

7. Place the ratchet advance lever (P) on the axle (A) of the cloth beam, next to the ratchet gear. Place a 3/8" washer on the axle (A) and a 3/8" washer on the axle in the other end of the cloth beam (15). Insert the cloth beam in the holes provided in the cloth beam supports (17 & 18).

FIGURE 4

8. Attach (#8 x 1-1/2" truss screw) the front castle cross brace (16) to the castle sides (9 & 10). This part has two holes (S). Make sure the square holes are at the top of the brace.

9. Attach (1/4" x 2" truss machine screw and barrel nut) the breast beam (25) with breast beam extension (26) facing forward and downward, to the legs (1 & 2).

10. Install the beater assembly on the bolts (B). Secure the beater with a slim lock nut on each bolt. Tighten the lock nuts, making sure the beater assembly pivots freely.

FIGURE 6

11. From the rear of the loom, insert the two aluminum jack pivot rods (A) into the larger holes of the front castle cross brace (16).

12. Place two 3/8" washers on each of the rods (A).

For 4-Shaft Looms: Place a #1 jack mechanism on the rods (A). Place a 3/8" washer

on each rod, followed by a second #1 jack mechanism. Continue with another washer, a #3 jack mechanism, another washer, and the second #3 jack mechanism. Finish by placing two more 3/8" washers on each rod.

For 8-Shaft looms: Place a #1 jack mechanism on the rods (A). Place a 3/8" washer on each rod, followed by a second #1 jack mechanism. Continue in the following order: another washer, the #2 jack mechanism, a washer, the second #2 jack mechanism, and a washer. Continue with the #3 jack mechanism, a washer, the second #3 jack mechanism, a washer, the #4 jack mechanism, a washer, and the second #4 jack mechanism for the 8S loom. Finish by placing two more 3/8" washers on each rod.

FIGURE 7

13. Attach (#8 x 1-1/2" truss screw) the rear castle cross brace (31) to the rear castle sides (1 & 2). Make sure the rods (A) fit into their correct holes.

FIGURE 6

14. Push the jacks (J) down in the center and insert the carriage bolts (1/4" x 4-1/2" for 4S, 1/4" x 7" for 8S) through holes (S) in the front castle cross brace (16) and on through the holes (T) in the rear castle cross braces (31). Align the square part of the carriage bolts in the square holes (S) and tap them firmly into the holes. Put a washer on each bolt and secure with a 1/4" lock nut. Do not tighten the lock nut all the way. The washer should remain loose.

FIGURE 8

15. Place the harness frames (50) into the channels in the castle sides. The heddle bar lock hooks (52) are slightly off-center and should be lined up on the same side of center when the harnesses are in the castle. Be sure the jack pin (JP) is inserted into the hole in the center of the bottom of the harness frame. It is a good idea to occasionally spray silicone lubricant on the

channels and the ends of the harnesses.

16. Put the small hex nuts (N) on the jack pins (JP), then push a small black O-ring on top of each hex nut.

17. Figure 7

18. Attach (1/4" x 2" truss head machine screws and barrel nuts) the rear leg brace (46) to legs (1 & 2).

19. Attach (#8 x 1-1/2" truss screws) the rear upper castle support (47) to the castle sides (9 & 10).

20. For 8-Shaft and 4Now-4Later Looms only: Attach (#8 x 1-1/4" flat screws) the treadle aid bar (32) to the rear castle cross brace (31).

FIGURE 9

21. Take the warp beam (40) and place a 3/8" USS washer on the metal pin in the end opposite the brake drum. Also place a 3/8" USS washer on the threaded rod (R) in the brake drum (D) and slip the threaded rod through the hole in the rear leg (4). Fit the pin in the other end into the hole in the rear leg (3). You will have to slightly spread apart the right and left legs to accomplish this.

22. Attach (1" truss head machine screw) the brake barrel nut (L) to the rear leg (4).

23. Attach the hook (H) to the hole on the rear of the brake cable bar. Loop the nylon brake cord (Q) through the hook on the brake cable bar. Slip the other end of the cord through the hole at the end of the brake pedal (5). Secure the cord by inserting the plastic brake peg into the 5th or 6th loop from the end of the nylon cord.

24. Put a 1/4" washer on bolt (B). Put the brake bar (43) and another 1/4" washer on bolt (B). Take the brake cable (C) and wrap it around the brake drum (D) as illustrated. Start at the side of the brake drum next to the loom legs and wrap going away from the legs. Place the loop end of the cable over the bolt (B) and put on another 1/4" washer and a slim 5/16" lock nut. Be sure that the brake bar can pivot freely.

25. Attach the brake spring (S) to the brake bar (43). Insert the eyebolt through a 3/16" washer, through the hole in the long barrel nut (L), and screw it back into the spring (S).

26. By tightening or loosening the eye bolt (E), you can increase or decrease the tension on the friction brake. There should be small gaps between the coils of the brake spring once the proper tension is reached. Tighten the eyebolt until you can't turn the warp beam away from you when you twist the beam with both hands. When you hold the brake release pedal down, the warp beam should turn freely in either direction.

FIGURE 10

27. Attach (2-1/4" black knob (T), fender washer (U), and barrel nut (V) the rear beam (45) to the rear legs (3 & 4).

28. Put the #6 x 1/2" round head screw through the hole in the end of the beater pin (P) chain and the hold in the beater pin holder, and screw it into the right leg (2).

Complete the assembly of your loom using the instruction manual included with the Accessory Packs.

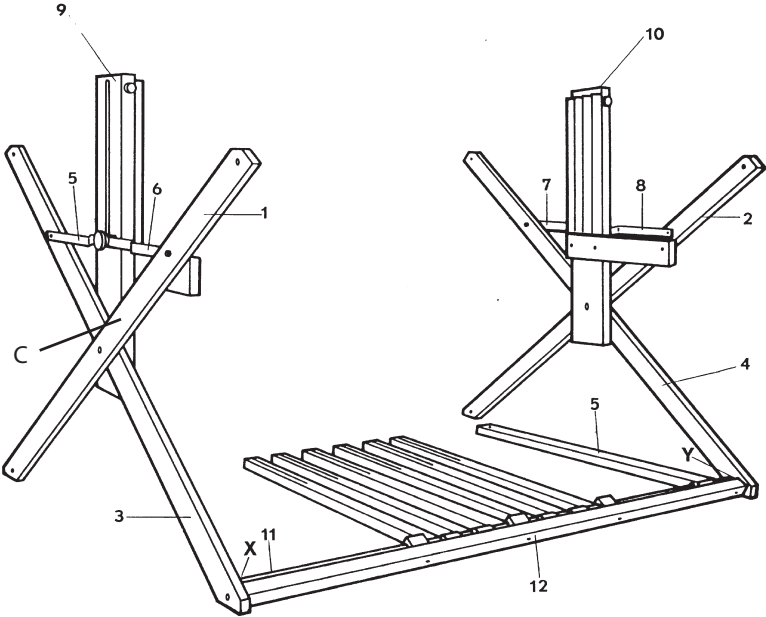

FIGURE 1

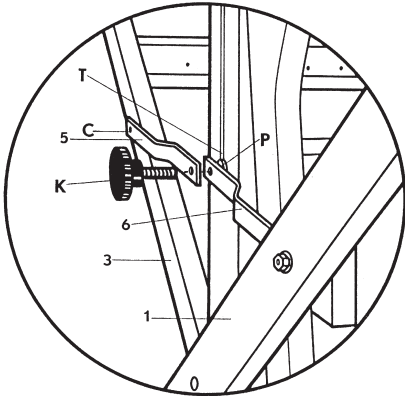

FIGURE 2

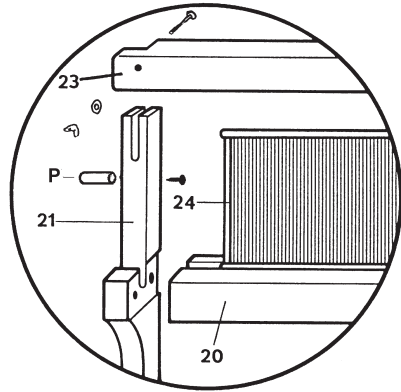

FIGURE 3

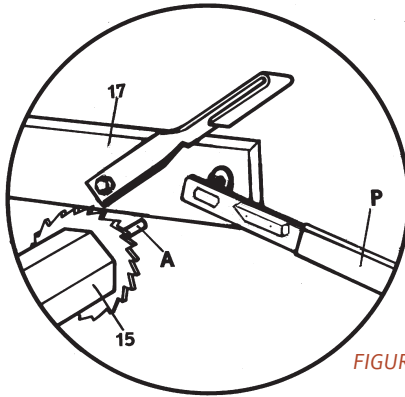

FIGURE 4

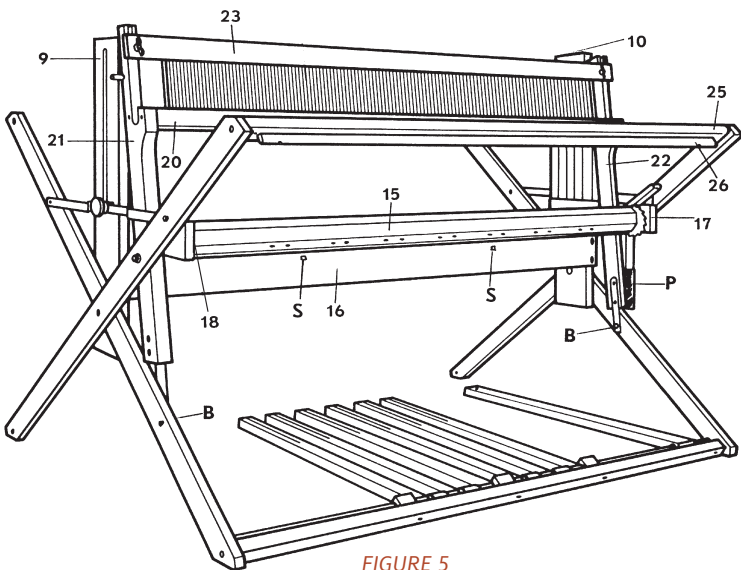

FIGURE 5

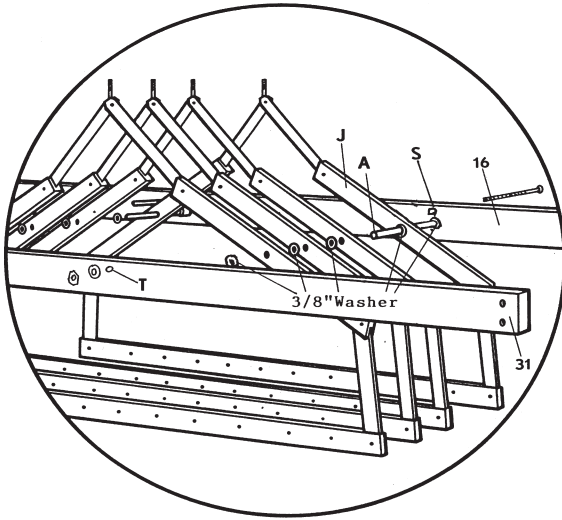

FIGURE 6

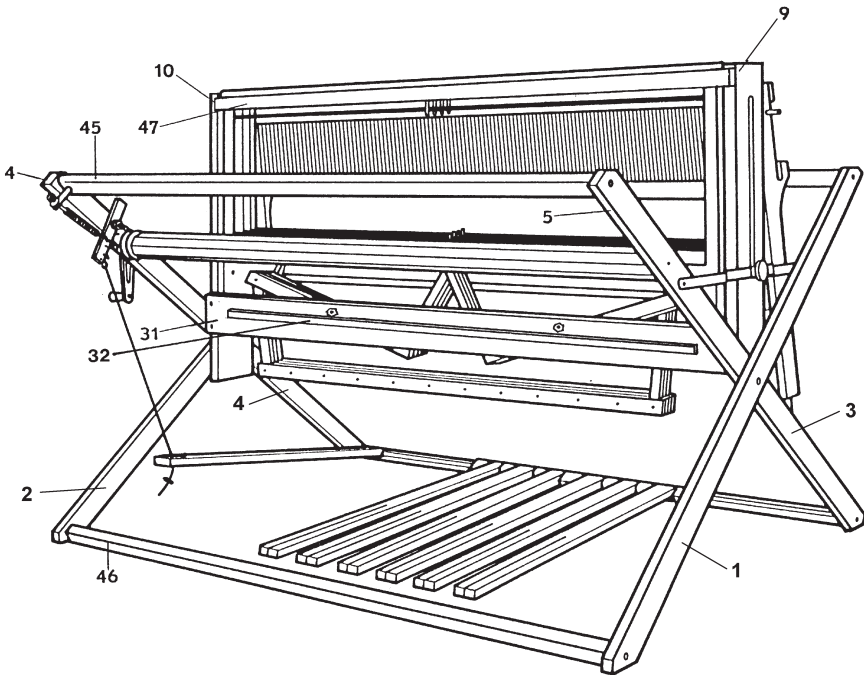

FIGURE 7

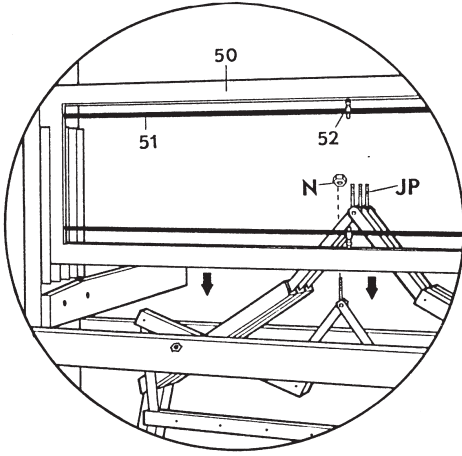

FIGURE 8

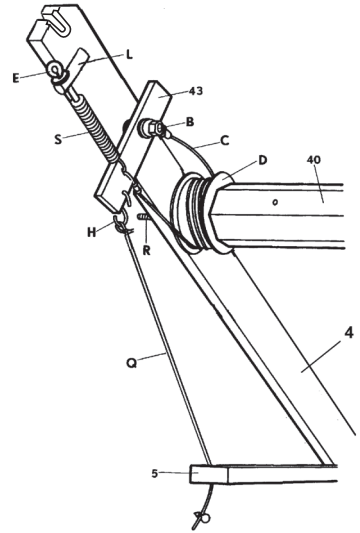

FIGURE 9

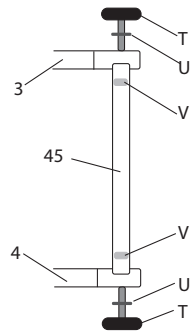
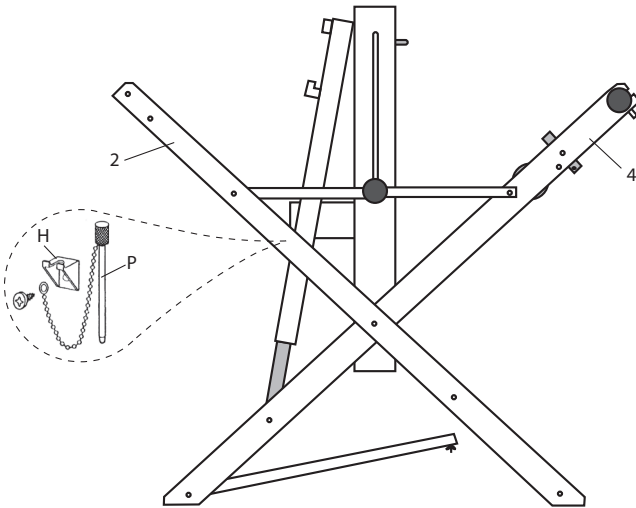

FIGURE 10