

WW7803
WW7804

ULTRA UMBRELLA SWIFT™

WITH AND WITHOUT COUNTER

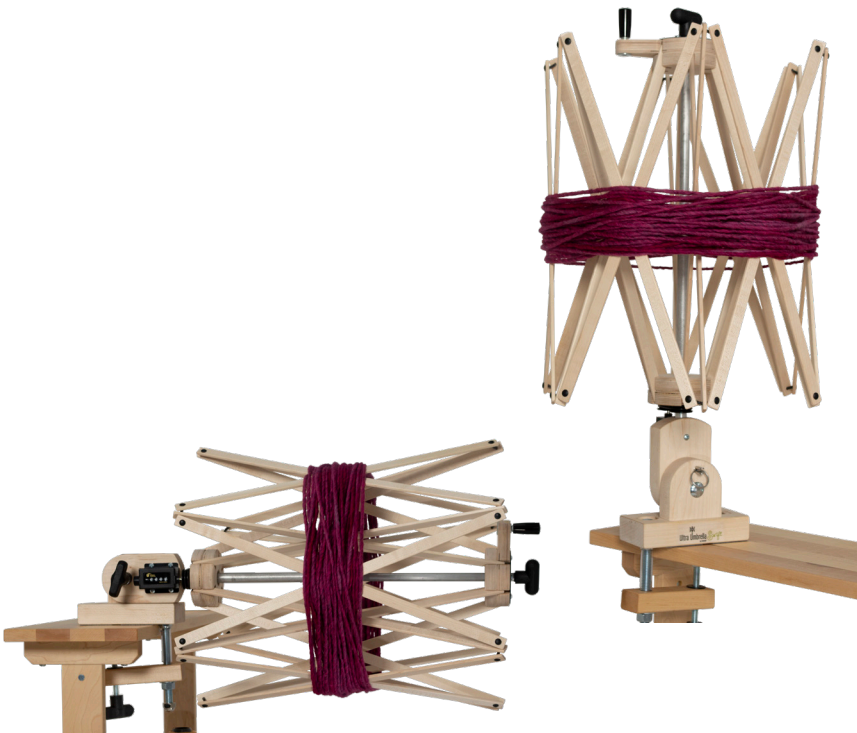

Find out more at schachtspindle.com

Schacht Spindle Company 6101 Ben Place Boulder, CO 80301

p. 303.442.3212 f. 303.447.9273

© 2021 Schacht Spindle Company, Inc.

07.21

ULTRA UMBRELLA SWIFT™

WITH AND WITHOUT COUNTER

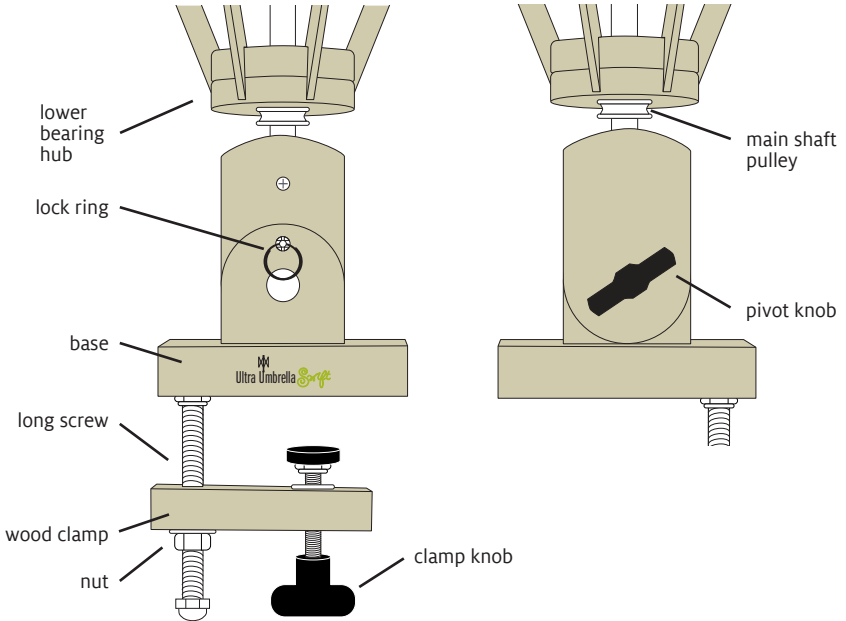
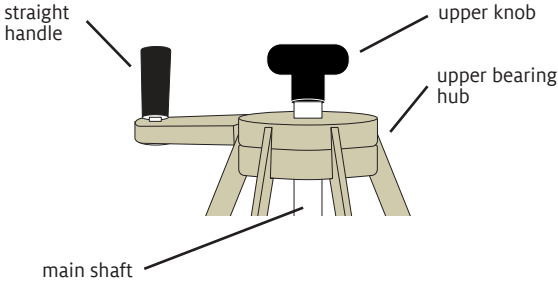

FIGURE 1: PARTS ON ALL SWIFTS

ALL SWIFTS

CLAMPING THE SWIFT TO A TABLE

1. Loosen the clamp knob (**counter-clockwise**) and the nut on the long screw to open the wood clamp enough so that it can fit under the table edge (Figures 1 and 2).
2. Slide the swift onto a table edge.
3. Tighten the nut until the wood clamp is level.
4. Tighten the clamp knob (**clockwise**) to secure the swift.

To remove the swift, loosen the clamp knob and slide the swift off the table edge. If you later put the swift on the same surface, you should not need to adjust the nut.

OPENING & USING THE SWIFT

1. Place a skein of yarn over the swift.
2. Slightly loosen the upper knob (Figure 1). Do not turn it more than a quarter turn.
3. Push down on the upper bearing hub to open the swift's arms.
4. Tighten the upper knob when the swift has opened as far as you want.

Once you pull the cut end of the skein, the swift will rotate easily. You can also use the straight handle on the top to turn the swift.

TILTING THE SWIFT

1. Stand to the side of the swift, on the side with the lock ring. Hold the swift by the T-knob at the top.
2. Loosen the pivot knob by turning it counter-clockwise a quarter turn.
3. Pull on the lock ring until the ring is past the post. (The lock ring does not come out of the base.) As you pull, tilt the main shaft parallel to the floor.
4. Release the lock ring—make sure it goes all the way into the base.
5. Tighten the pivot knob by turning it clockwise a quarter turn.

To move the swift to an upright position, follow the same steps. In Step 3, return the main shaft to its vertical position.

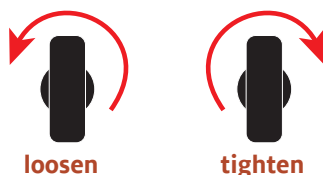

FIGURE 2: USING KNOBS

CLOSING THE SWIFT

1. Slightly loosen the upper knob—do not turn more than a quarter turn.
2. Push up on the upper bearing hub to close the swift's arms.
3. Tighten the upper knob to secure the swift in its closed position.

Never push or pull on the upper knob to open or close the Ultra Umbrella Swift—this can damage the swift's ability to lock securely in the desired position. Always use the upper bearing hub to open or close your swift.

SWIFTS WITH COUNTERS

USING THE COUNTER

Set the counter by turning the counter reset knob clockwise, through 9999 to 0000 (Figure 3).

Turn the swift clockwise to count up. Turn the swift counter-clockwise to count down.

The counter counts revolutions of the swift. You will need to measure the circumference of the skein and multiply by the number on the counter to get the length of the skein. The calculated length will not be exact as the length of each wrap of yarn in the skein will vary.

You may find it helpful to use a pre-measured string to open the swift to a specific circumference. ■

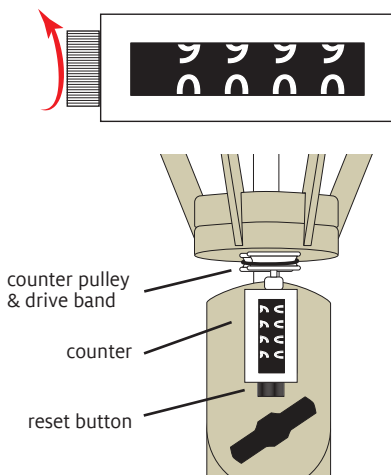

FIGURE 3: COUNTER PARTS

SCHACHT WINDING ACCESSORIES



Clamp your Ultra Umbrella Swift or other winding tools to our Winding Station. Add cones, bobbins, and spools at the bottom.



Our Niddy Noddy folds flat for travel and collapses to make it easy to remove your yarn. Adjustable for 1.5 and 2 yard skeins. Available in cherry or maple.